



Public and  
Government Buildings

For all HOPPE door- and window handles ...





Hardware from HOPPE: Simple – durable – secure

page 4

---



Education

page 6

---



Healthcare

page 10

---



Leisure and Hospitality

page 14

---



Products

page 19

---

## How schools, hospitals and leisure centres benefit from HOPPE hardware

Education, healthcare and leisure buildings are the ultimate testing ground for door hardware. In such high-traffic environments, handles, hinges, locks and closers must be able to withstand many years of rough treatment and abuse.

But choosing the right door hardware for your project isn't just a question of durability. Finding attractive products that are easy to install and even easier to maintain is essential, too.

## Simple installation

### Products to suit the most demanding environments

- Lever handles
- Door controls
- Panic and emergency
- Locks and latches
- Cylinders
- Architectural hinges
- Pull handles

Installing or replacing hardware on hundreds of doors can be a slow and laborious task. Our Quick-FitPlus handles can be fitted in just eight seconds. What's more, the Quick-Fit Plus range can be installed by anyone – no specialist skills or tools are needed.

## Effortless maintenance

Across the HOPPE range, we've designed products that allow you to take a 'fit and forget' approach to maintenance. We test all our non-residential handles by subjecting them to the equivalent of 70 operational cycles a day over a 10-year period. Neither the door handle itself, nor any part of it, must become loose during the test.

## Attractive design

Whether you're considering products from our HOPPE or ARNONE ranges, you can expect to find a variety of styles and finishes, including aluminium, brass, polyamide nylon and stainless steel. Our polyamide nylon range of handles is available in a selection of colours, which can be specified to match your unique colour scheme.

HOPPE (UK) Ltd. has been supplying door hardware for the UK education, healthcare and leisure sectors since 1997. With a range of products ideally suited to these high-traffic environments, you can be sure to find the solution you're looking for.

## First class service – from specification to installation and after care

At HOPPE, the high quality standards go far beyond our products. Our network of trusted architectural ironmongery partners strive to deliver the service you expect. From product advice to specification support, our expert teams are on hand to help with planning, installation and after care.

## Superior technical and aftersales support

Experienced HOPPE product experts are always available to answer your queries and concerns. Just contact your architectural ironmonger, who'll be happy to assist you. You can also visit our website where you will find a selection of manuals, videos and product selection tools to help you choose the right hardware for your project.

## 10-year guarantee

HOPPE gives a 10-year guarantee on the mechanical operation of all door and window handles, as long as the assembly and maintenance guidelines are followed. This gives you long-term peace of mind when you choose door hardware from HOPPE.



## Tried, tested and proven

All HOPPE products undergo numerous tests to ensure flawless operation in high-traffic areas. Static impact tests and durability tests are also made depending on the product type. These closely reflect the everyday knocks hardware has to take and extend beyond the tests and requirements of technical standards such as DIN EN 1906.

As with all of our products, HOPPE break-in protection solutions are characterised by the following **brand attributes**:



10-year guarantee on the mechanical operation



Made in Europe



DIN EN ISO 14001  
Environmentally-considerate manufacturing









## How HOPPE meets your needs: Education

Across the UK, schools, colleges and universities have cut refurbishment timescales, routine maintenance costs and emergency repair bills by fitting door hardware from HOPPE.

### The challenge

Whether your campus is one building or thirty, tackling issues such as every-day wear and tear and acts of vandalism to door hardware can be a daunting prospect. You also need to make sure the hardware provides a high level of security and safety for your students and staff.

### The HOPPE solution

We have a complete range of door hardware, which is designed to withstand heavy usage and repeated abuse, while providing safety and security features as standard. In addition, all our products meet the highest UK and European performance and quality standards and legislation.

Visit <http://www.hoppe.com/gb/en/home> to learn more about us

### Quick-FitPlus handle

Key advantages:

- All the advantages of our patented HOPPE Quick-Fit connection
- Numerous combination possibilities of handles made of brass, stainless steel and aluminium, with round or square roses
- Easy and precise assembly of the whole door handle set (flat roses and door handles) in just eight seconds and without the need for screws
- Suitable for renovation, thanks to the extra-large flat roses

### EN 1906 lever handles

Key advantages:

- Our Paris and Marseille designs are ideal for healthcare buildings and can include pull handles, escutcheons, and turn and releases to your specification
- Tested to DIN EN 1906: 37-B140U, handle set for commercial applications
- Maintenance-free slide bearing
- Very high corrosion resistance – meets EN 1670, grade 4
- Concealed fixings, using M4 thread screws with sleeve nuts or multi-purpose screws
- Grade 4 category of use options also available for higher usage doors

Quick-FitPlus<sup>1</sup>





## Nylon range

Key advantages:

- Our Paris design is a cost-effective and hard-wearing handle ideal for education applications
- Wide range of colours, which can be specified to match your unique colour scheme
- Maintenance-free slide bearing
- Concealed fixings, using multi-purpose screws
- Connected by using the HOPPE solid profile spindle



## ARRONE range

Key advantages:

- A complete range of door handles and architectural hardware, including cylinders, hinges, door controls, locks and latches, closers, and panic and emergency hardware
- 5- or 10-year operational guarantee on all ARRONE products
- Certified test house Exova puts our products through rigorous testing so that they can be specified with confidence
- Very high corrosion resistance – meets EN 1670, grade 4
- All of our products which fall under the scope of a harmonised standard are fully CE marked so they can be used on fire doors

**ARRONE®**  
The **complete** range.











## How HOPPE meets your needs: Healthcare

In the face of dwindling budgets, hospitals and health centres are tackling accessibility, security and maintenance issues by installing HOPPE's range of durable and cost-effective door hardware.

### The challenge

Cramped and out-dated facilities are an ongoing challenge for healthcare workers and patients alike. Where investment in brand new or refurbished premises has taken place, the need to find cost-effective door hardware that keeps premises accessible, secure and comfortable for patients and staff is crucial.

### The HOPPE solution

The HOPPE and ARRONE ranges feature handles, locks, cylinders, hold-open devices, and panic and escape hardware – all uniquely suited to high traffic, heavy-duty healthcare applications. Our products are manufactured to the highest standards and are fully CE marked for optimum performance and maintenance-free peace of mind.

Visit <http://www.hoppe.com/gb/en/home> to learn more about us



### EN 1906 lever handles

Key advantages:

- Our Paris and Marseille designs are ideal for healthcare buildings and can include pull handles, escutcheons, and turn and releases to your specification
- Tested to DIN EN 1906: 37-B140U, handle set for commercial applications
- Maintenance-free slide bearing
- Very high corrosion resistance – meets EN 1670, grade 4
- Concealed fixings, using M4 thread screws with sleeve nuts or multi-purpose screws
- Grade 4 category of use options also available for higher usage doors

## Nylon range

Key advantages:

- Our Paris design is a cost-effective and hard-wearing handle ideal for healthcare applications
- Wide range of colours, which can be specified to match your unique colour scheme
- Maintenance-free slide bearing
- Concealed fixings, using multi-purpose screws
- Connected by using the HOPPE solid profile spindle



## ARRONE range

Key advantages:

- A complete range of door handles and architectural hardware, including cylinders, hinges, door controls, locks and latches, closers, and panic and emergency hardware
- 5- or 10-year operational guarantee on all ARRONE products
- Certified test house Exova puts our products through rigorous testing so that they can be specified with confidence
- Very high corrosion resistance – meets EN 1670, grade 4
- All of our products which fall under the scope of a harmonised standard are fully CE marked so they can be used on fire doors

**ARRONE®**  
The **complete** range.









## How HOPPE meets your needs: Leisure and hospitality

HOPPE hardware is helping leisure and hospitality building owners eliminate corrosion issues, reduce high-traffic wear and tear, and drive down maintenance costs.

### The challenge

Door hardware in leisure and hospitality buildings – such as sports centres and swimming pools – is subjected to frequent abuse and rough treatment, as well as high levels of moisture and corrosion. Spiralling lifecycle costs can result from hardware that needs regular maintenance and replacement due to wear and tear and corrosion.

### The HOPPE solution

HOPPE has designed a selection of door hardware products that meet EN 1670 grade 4 standards for corrosion resistance. What's more, the hardware can be specified in both aluminium and stainless steel finishes, which provide an attractive, maintenance-free and cost-effective solution for your leisure or hospitality project.

Visit <http://www.hoppe.com/gb/en/home> to learn more about us



### EN 1906 lever handles

Key advantages:

- Our Paris and Marseille designs are ideal for healthcare buildings and can include pull handles, escutcheons, and turn and releases to your specification
- Tested to DIN EN 1906: 37-B140U, handle set for commercial applications
- Maintenance-free slide bearing
- Very high corrosion resistance – meets EN 1670, grade 4
- Concealed fixings, using M4 thread screws with sleeve nuts or multi-purpose screws
- Grade 4 category of use options also available for higher usage doors

## ARRONE range

Key advantages:

- A complete range of door handles and architectural hardware, including cylinders, hinges, door controls, locks and latches, closers, and panic and emergency hardware
- 5- or 10-year operational guarantee on all ARRONE products
- Certified test house Exova puts our products through rigorous testing so that they can be specified with confidence
- Very high corrosion resistance – meets EN 1670, grade 4
- All of our products which fall under the scope of a harmonised standard are fully CE marked so they can be used on fire doors

**ARRONE®**  
The **complete** range.







Hinges



Signs

Products

Hinges.....20

Pull handles .....22

Door handles.....24

Bathroom furniture.....28

Door Controls.....30

Panic and Emergency Exit Hardware .....32

Locks .....37

Cylinders .....41

Mechanical Push Button.....42

Hooks .....43

Floor Fix Door Stop.....44

Signs.....45

Shelving.....46

Finish Chart .....47

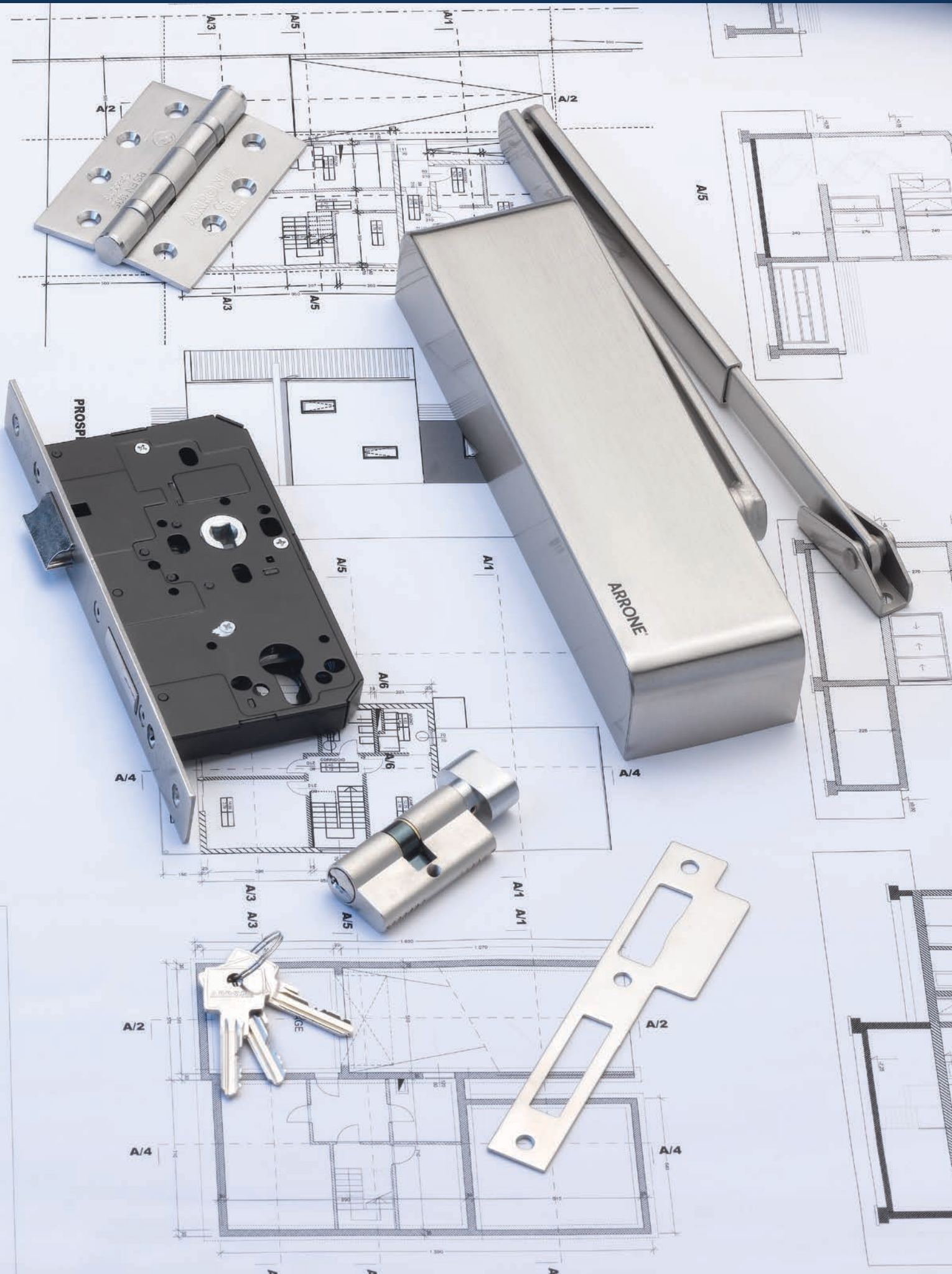

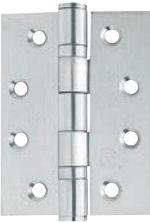

AR8180

- ARRONE® 2 ball bearing stainless steel Grade 13 square corner butt hinge:
- Dimensions: 102x76x3mm
  - Suitable for doors weighing up to 120kg (Grade 13)
  - Supplied with 16 x 201 grade stainless steel pozi countersunk wood screws
  - Successfully type tested for conformity to all the requirements of **BS EN1935: 2002**
- Grade 13**

4	7	6	1*	1	4	0	13
---	---	---	----	---	---	---	----

- CE Marked: Certificate 1121-CPD-AC0070
- CPR Declaration of Performance: HUK0016
- Certifire approved: Certificate CF369
- Intumescent pack available separately for use on timber fire doors (AR/INT-8180/8580)

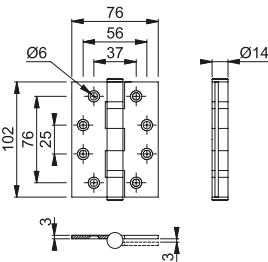

AR8582

- ARRONE® concealed bearing stainless steel Grade 13 radius corner butt hinge:
- Dimensions: 102x76x3mm
  - Sold as 1½ pairs
  - Supplied with stainless steel pozi countersunk wood screws.
  - Suitable for doors up to 120kg weight
  - Successfully type tested for conformity to all the requirements of **BS EN1935: 2002**
- Grade 13**

4	7	6	1*	1	4	0	13
---	---	---	----	---	---	---	----

- CE Marked: Certificate 1121-CPD-AC5027
- CPR Declaration of Performance: HUK0050
- Certifire approved: Certificate CF5197
- Intumescent pack available separately for use on timber fire doors (AR/INT-8180/8580)

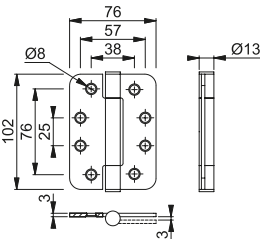

Included in a successful fire test to BS EN1634 Part-1. Suitable for use on 30 and 60 minute timber fire doors (Intumescent pack must be used)





## AR8380

ARRONE® phosphor bronze bearing stainless steel Grade 13 square corner butt hinge:

- Dimensions: 100x88x3mm
- Sold as 1½ pairs
- Supplied with stainless steel pozi countersunk wood screws
- Suitable for doors up to 120kg weight
- Successfully type tested for conformity to all the requirements of **BS EN1935:**

### 2002 Grade 13

4	7	6	1*	1	4	0	13
---	---	---	----	---	---	---	----

- CE Marked: Certificate 1121-CPD-AC5027
- CPR Declaration of Performance: HUK0049
- Certifire approved: Certificate CF5197
- Intumescent pack available separately for use on timber fire doors (AR/INT-8680/8380)

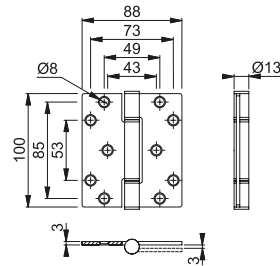

Included in a successful fire test to BS EN1634 Part-1. Suitable for use on 30 and 60 minute timber fire doors (Intumescent pack must be used)

## ■ AR-5020 (AR203BF)

ARRONE® bolt through fixing pull handle:

- 19mm diameter x 425mm
- Bolt type: M8

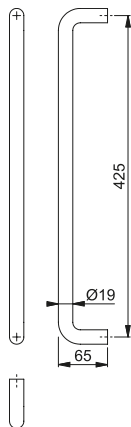

### Conformity statement:

Pull handles with a length of 300mm and above meet the dimensional recommendations of BS8300 and ADM.

Included in a successful fire test to BS EN1634 Part-1. Assessed for use on 30 and 60 minute timber fire doors

## ■ EX5040 (AR3616BF)

HOPPE stainless steel straight bolt through pull handle:

- 20mm diameter

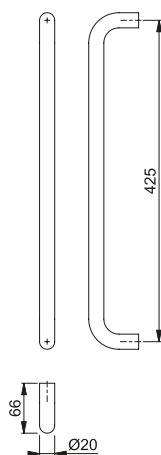

duraplus®

316

Included in a successful fire test to BS EN1634 Part-1. Assessed for use on 30 and 60 minute timber fire doors

■ **K5030-3 (AR602BF)**

durap<sup>plus</sup>®

HOPPE nylon straight bolt through fixing pull handle pair:

- 34mm Diameter
- For 425 and 600mm, pull handle contains a modular feature consisting of 3 parts

Included in a successful fire test to BS EN1634 Part-1. Assessed for use on 30 and 60 minute timber fire doors

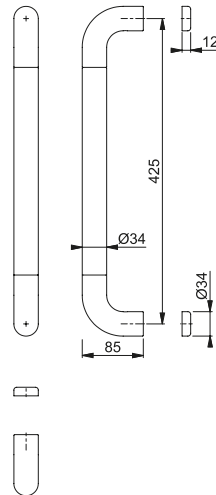
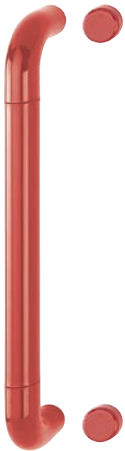





Quick-Fit

Quick-FitPlus

## ■ Marseille - E1138Z/849N

duraplus®

**HOPPE Quick-FitPlus** stainless steel handle set on flat rose without escutcheons for interior doors:

- Tested to **DIN EN 1906: 37-0140U**, handle set for commercial applications
- Bearing: loose door handles, maintenance-free slide bearing
- Connection: **HOPPE Quick-Fit** connection with HOPPE solid spindle (spindle - receiver components)
- Fixing: plug-in handle roses with supporting lugs
- Special feature: non-screw and tool-free fitting, 2mm flat roses



Included in successful fire test to BS EN1634 part-1. Assessed for use on 30 minute timber fire doors.

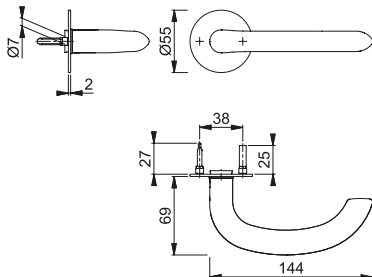

## ■ Paris - 138S/42K (AR200S/10) - Sprung

duraplus®

HOPPE aluminium handle set on rose without escutcheons for interior doors:

- Bearing: sprung fixed/movable door handles, maintenance-free slide bearing
- Connection: HOPPE solid profile spindle
- Base: nylon
- Fixing: bolt through

Included in successful fire test to BS EN1634 part-1. Assessed for use on 30 minute timber fire doors.

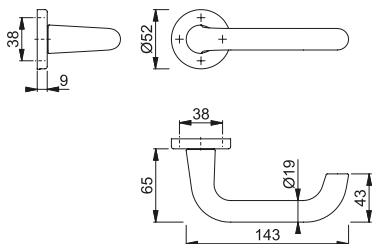



### ■ Paris - EX138Z/42 (AR361/60)

duraplus®

HOPPE stainless steel handle set on rose without escutcheons for interior doors:

- Tested to DIN EN 1906: 37-B150A, handle set for commercial applications
- Bearing: sprung fixed/movable door handles, maintenance-free slide bearing
- Connection: solid spindle with eccentric hole on both ends
- Base: stainless steel
- Fixing: concealed, M4 thread screws with sleeve nuts or multi-purpose screws



Included in successful fire test to BS EN1634 part-1. Assessed for use on 30 minute timber fire doors.

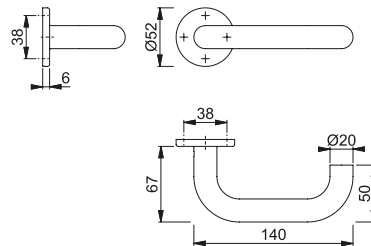

### ■ Paris - EX138Z/42

duraplus®

HOPPE stainless steel handle set on rose without escutcheons for interior doors

- Tested to DIN EN 1906: 47-B150A, handle set for commercial applications
- Bearing: sprung fixed/movable door handles, maintenance-free slide bearing
- Connection: hardened HOPPE solid profile spindle
- Base: stainless steel
- Fixing: concealed, M4 thread screws with sleeve nuts or multi-purpose screws

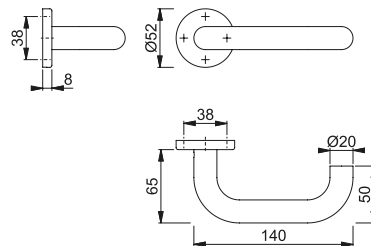



Quick-Fit

Quick-FitPlus

## Paris - E138Z/849N

duraplus®

**HOPPE Quick-FitPlus** stainless steel handle set on flat rose without escutcheons for interior doors:

- Tested to **DIN EN 1906: 37-0140U**, handle set for commercial applications
- Bearing: loose door handles, maintenance-free slide bearing
- Connection: **HOPPE Quick-Fit** connection with HOPPE solid spindle (spindle - receiver components)
- Fixing: plug-in handle roses with through-going supporting lugs
- Special feature: non-screw and tool-free fitting, 2 mm flat roses



Included in successful fire test to BS EN1634 part-1. Assessed for use on 30 minute timber fire doors.

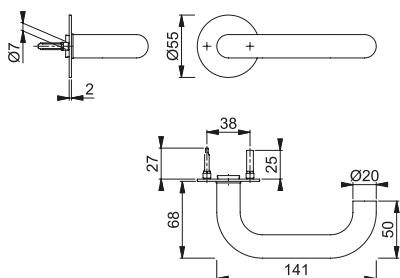

## Paris K138/353K (AR600)

duraplus®

HOPPE nylon handle set on short backplate for interior doors:

- Bearing: loose door handles, maintenance-free slide bearing
- Connection: HOPPE solid profile spindle (receiver - receiver components)
- Base: nylon
- Fixing: wood screws
- Special feature: door handles with steel cores

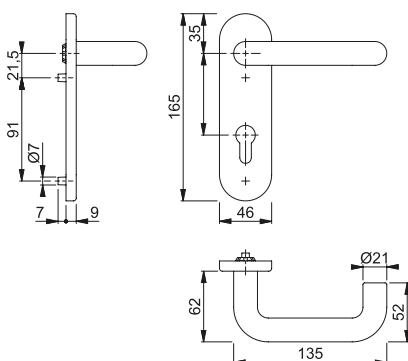





Quick-Fit<sup>1</sup>  
Quick-FitPlus<sup>1</sup>

## ■ Rotterdam - E1401Z/849N

duraplus®

**HOPPE Quick-FitPlus** stainless steel handle set on flat rose without escutcheons for interior doors:

- Tested to **DIN EN 1906: 37-0140U**, handle set for commercial applications
- Bearing: loose door handles, maintenance-free slide bearing
- Connection: **HOPPE Quick-Fit connection** with HOPPE solid spindle (spindle - receiver components)
- Fixing: plug-in handle roses with through-going supporting lugs
- Special feature: non-screw and tool-free fitting, 2 mm flat roses

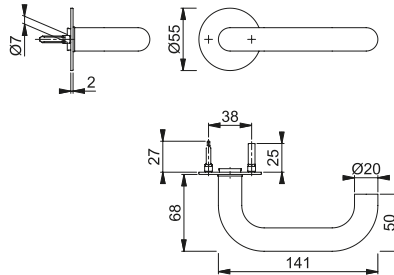

## AR361/10-4-SP-SSS

HOPPE stainless steel handle set on rose without escutcheons for interior doors

- Tested to **DIN EN 1906: 47-B150A**, handle set for public applications
- Bearing: sprung fixed/movable door handles, maintenance-free slide bearing
- Connection: Hardened full profile spindle
- Base: stainless steel
- Fixing: concealed, M4 thread screws with sleeve nuts or multi-purpose screws
- Product type: Set (handle/handle)
- Finish: F69 satin stainless steel
- Category of use: Category of use grade 4 to
- **DIN EN 1906**
- Door thickness: 40-50 mm
- Spindle size: 8 mm

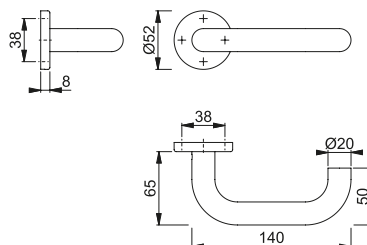



## 42KS

HOPPE aluminium escutcheon pair with emergency release/turn and red-white-indicator for bathroom/WC doors:

- Base: nylon
- Fixing: wood screws

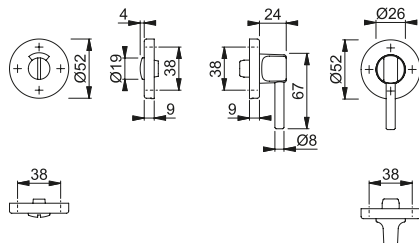

duraplus®



## EX42S

HOPPE stainless steel escutcheon pair with emergency release/turn and red-white-indicator for bathroom/WC doors:

- Base: steel
- Fixing: wood screws

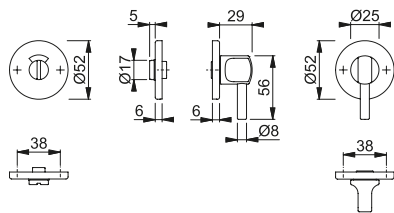

duraplus®

316



Quick-FitPlus

## E849NS

**HOPPE Quick-FitPlus** stainless steel flat escutcheon pair with emergency release/turn and red-white-indicator for bathroom/WC doors:

- Fixing: plug-in escutcheons with supporting lugs
- Special feature: non-screw and tool-free fitting, 2 mm flat roses

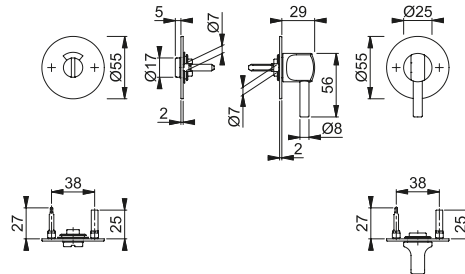

duraplus®



## AR751/15

ARRONE® reversible facility furniture:

- Suitable for hinged or sliding doors
- Red / white indicator
- Emergency coin release

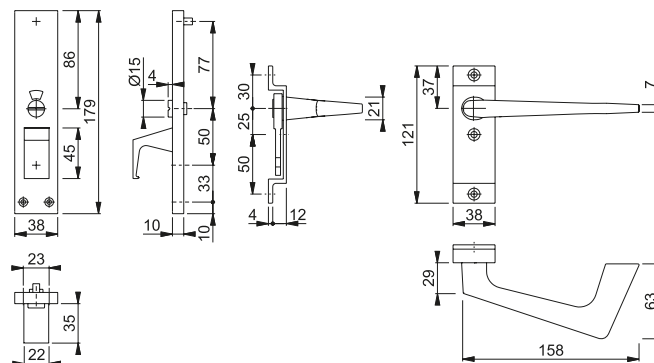





AR1500

- ARRONE® overhead door closing device:
- Power adjustable power size 2-4 by spring
  - Backcheck
  - Semi radiused cover
  - Suitable for doors up to 1100mm wide and 80kg weight when fitted in Fig 1, Fig 6 & Fig 61 fixing positions
  - Fixing points retrofit other popular British closers of a similar application
  - Successfully type tested for conformity to all the requirements of BS EN1154:1997

Fig 1, 6 and 61	3	8	4 2	1*	1	4
-----------------	---	---	--------	----	---	---

- CE Marked: Certificate 1121-CPD-AD0124
- Certifire Approved Product: Certificate CF294
- CPR Declaration of Performance Certificate: HUK0001

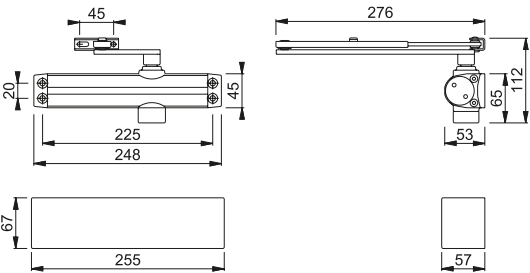

The AR1500 can satisfy the opening force recommendations of BS8300 and AD-M when fitted in Fig 1 to a door with minimum width of 938mm according to third party data. However other installed hardware, door seals and differential air pressure will affect the products as fitted performance meaning that the door closer alone cannot allow compliance to BS8300 and AD-M.

Included in a successful fire test to BS EN1634 Part-1. Suitable for use on 30, 60 and 120 minute timber fire doors



AR5500

- ARRONE® overhead door closing device:
- Power adjustable 2-5 (Size 2 by template, size 3-5 by spring)
  - Backcheck
  - Slimline cover
  - Covers available in Stainless Steel 316 on request
  - Suitable for doors up to 1250mm wide and 100kg weight when fitted in Fig 1
  - Suitable for doors up to 1100mm wide and 80kg weight when fitted in Fig 6 & 61
  - Successfully type tested for conformity to all the requirements of BS EN1154:1997

Fig 1	4	8	5 2	1*	1	4
Fig 6	3	6	4 3	1*	1	4
Fig 61	4	8	4 2	1*	1	4

- CE Marked: Certificate 1121-CPD-AD0239
- Certifire Approved Product: Certificate CF295
- CPR Declaration of Performance Certificate: HUK0005

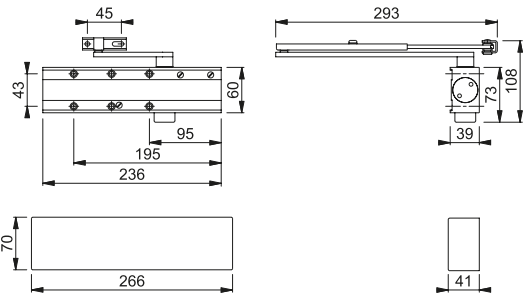

Included in a successful fire test to BS EN1634 Part-1. Suitable for use on 30, 60 and 120 minute timber and 240 minute steel fire doors

## AR7383



ARRONE® overhead door closing device:

- Power adjustable power size 2-4 by spring
- High performance concealed cam action mechanism with slide track
- Suitable for doors up to 1100mm wide and 80kg weight
- Intumescent kit available
- Successfully type tested for conformity to all the requirements of BS EN1154:1997

3	8	4 2	1*	1	3
---	---	--------	----	---	---

- CE Marked: Certificate 1121-CPD-AD5071
- Certifire Approved Product: Certificate CF5181
- CPR Declaration of Performance Certificate: HUK0026

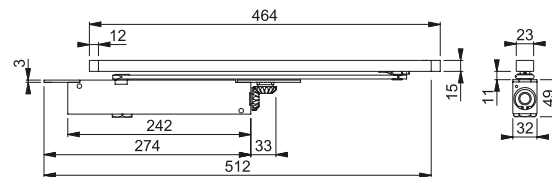

The AR7383 can satisfy the opening force recommendations of BS8300 and AD-M when fitted to a door with minimum width of 777mm (standard mount) and 796mm (transom mount) according to third party data. However other installed hardware, door seals and differential air pressure will affect the products as fitted performance meaning that the door closer alone cannot allow compliance to BS8300 and AD-M.

Included in a successful fire test to BS EN1634 Part-1. Suitable for use on 30, 60, 90 and 120 minute timber and 240 minute steel fire doors

## AR1998



ARRONE® overhead electromagnetic door closing device:

- Power size 4
- Hold open or swing free operation
- Flowline cover
- Suitable for doors up to 1100mm wide and 80kg weight when fitted in Fig 1
- Suitable for doors up to 950mm wide and 60kg weight when fitted in Fig 6
- Successfully type tested for conformity to all the requirements of BS EN1155:1997

Fig 1	3	8	4	1*	1	3
Fig 6	3	8	3	1*	1	3

- CE Marked: Certificate 1121-CPD-AE0017
- Certifire Approved Product: Certificate CF494
- CPR Declaration of Performance Certificate: HUK0006

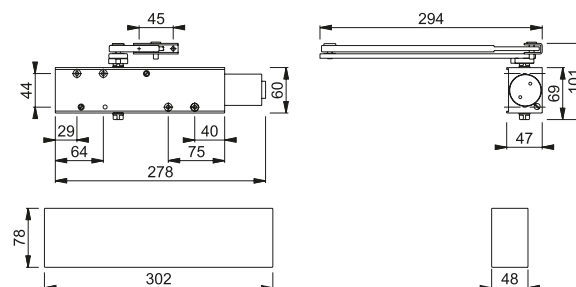

Included in a successful fire test to BS EN1634 Part-1. Suitable for use on 30, 60 and 120 minute timber and 240 minute steel fire doors

# Panic and Emergency Exit Hardware

## AR880

- ARRONE® single panic bolt:
- Fully reversible - Suitable for left and right handed doors
  - Suitable for use on doors up to 2440mm height x 1220mm width
  - Suitable for use on doors weighing up to 200kg
  - Supplied with "Push Bar To Open" signage
  - Steel door fixings and strike plates available separately
  - Successfully type tested to all the requirements of **BS EN1125:2008**

3	7	6	B	1	4	2	2	A	A
---	---	---	---	---	---	---	---	---	---

- CE Marked: Certificate: 1121-CPR-AAA005
- CPR Declaration of Performance: HUK0022
- Certifire approved: Certificate CF810

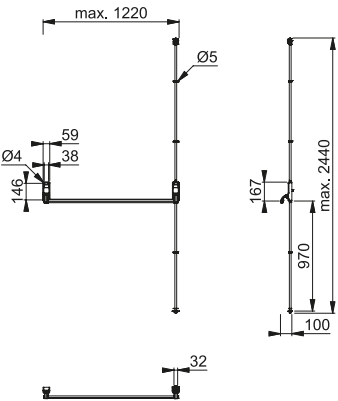

Included in a successful fire test to BS EN1634 Part-1. Suitable for use on 30, 60 and 120 minute timber and 240 minute steel fire doors

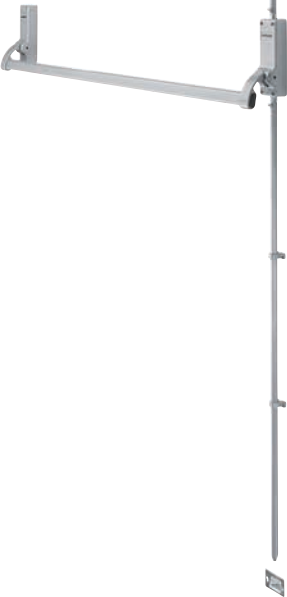

## AR882

- ARRONE® single panic latch:
- Fully reversible - Suitable for left and right handed doors
  - Suitable for use on doors up to 1220mm width
  - Suitable for use on doors up to 200kg
  - Supplied with "Push Bar To Open" signage
  - Steel door fixings and strike plates available separately
  - Successfully type tested to all the requirements of **BS EN1125:2008**

3	7	6	B	1	4	2	2	A	A
---	---	---	---	---	---	---	---	---	---

- CE Marked: Certificate: 1121-CPR-AAA005
- CPR Declaration of Performance: HUK0022
- Certifire approved: Certificate CF810

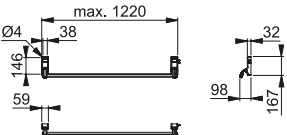

Included in a successful fire test to BS EN1634 Part-1. Suitable for use on 30, 60 and 120 minute timber and 240 minute steel fire doors





## AR885



ARRONE® single lift pad outside access device:

- Suitable for left and right handed doors
- Suitable for use on doors weighing up to 200kg
- Supplied with 40mm single cylinder and fixing pack for combination with internal exit device
- Successfully type tested as part of both single and double door sets in accordance with the requirements of **BS EN1125:2008** and **BS EN179:2008**
- Included as an accessory within CPR Declaration of Performance: HUK0022 & HUK0023 Certifire approved: Certificate CF810
- Lift pad contains internal snap feature, designed to make device inoperable in the event of excessive force or abuse

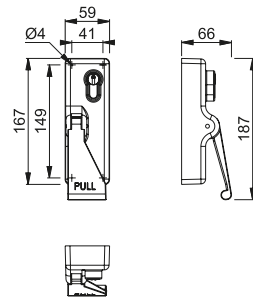

Included in a successful fire test to BS EN1634 Part-1. Suitable for use on 30 minute timber fire doors

## AR885K



ARRONE® single octagonal knob outside access device:

- Octagonal knob Design - Suitable for two way operation
- Fully Reversible - suitable for left and right handed doors
- Suitable for use on doors weighing up to 200kg
- Supplied with 40mm single cylinder and fixing pack for combination with internal exit device
- Successfully type tested as part of both single and double door sets in accordance with the requirements of **BS EN1125:2008** and **BS EN179:2008**
- Included as an accessory within CPR Declaration of Performance: HUK0022 & HUK0023
- Certifire approved: Certificate CF810

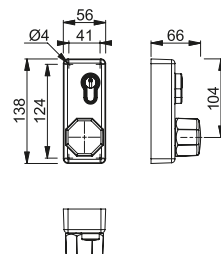

Included in a successful fire test to BS EN1634 Part-1. Suitable for use on 30 minute timber fire doors

# Panic and Emergency Exit Hardware

## AR886



ARRONE® single lift pad outside access device:

- Suitable for left and right handed doors
- Suitable for use on doors weighing up to 200kg
- Supplied without cylinder to allow for master keyed cylinders
- Option available with cylinder (See AR885)
- Successfully type tested as part of both single and double door sets in accordance with the requirements of **BS EN1125:2008** and **BS EN179:2008**
- Included as an accessory within CPR Declaration of Performance: HUK0022 & HUK0023
- Certifire approved: Certificate CF810
- Lift pad contains internal snap feature, designed to make device inoperable in the event of excessive force or abuse

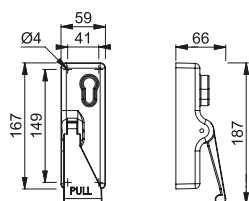

Included in a successful fire test to BS EN1634 Part-1. Suitable for use on 30 minute timber fire doors

## AR886K



ARRONE® single octagonal knob outside access device:

- Octagonal knob Design - Suitable for two way operation
- Suitable for left and right hung doors
- Suitable for use on doors weighing up to 200kgs
- Supplied without cylinder to allow for master keyed cylinders
- Successfully type tested as part of both single and double door sets in accordance with the requirements of **BS EN1125:2008** and **BS EN179:2008**
- Included as an accessory within CPR Declaration of Performance: HUK0022 & HUK0023
- Certifire approved: Certificate CF810

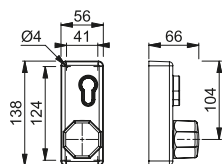

Included in a successful fire test to BS EN1634 Part-1. Suitable for use on 30 minute timber fire doors

## AR8800-3

ARRONE® touchbar panic bolt- 3 point:

- Fully Reversible - Suitable for left and right handed doors
- Suitable for use on doors up to 2440mm height x 750mm to 1000mm width
- Suitable for use on doors weighing up to 200kg
- Vertical Pullman latches
- Supplied with "Push Bar To Open" signage
- Successfully type tested to all the requirements of **BS EN1125:2008**

3	7	6	B	1	3	2	2	B	A
---	---	---	---	---	---	---	---	---	---

- CE Marked: Certificate: 1121-CPR-AAA5002
- CPR Declaration of Performance: HUK0036
- Certifire approved: Certificate CF5180

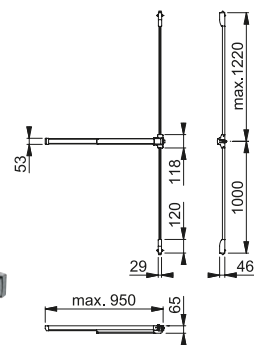

Included in a successful fire test to BS EN1634 Part-1. Suitable for use on 30, 60 and 120 minute timber and 240 minute steel fire doors





# Panic and Emergency Exit Hardware



## AR8805

ARRONE® return to door lever operated external locking attachment:

- Return to door lever design - Suitable for two way operation
- Fully Reversible - Suitable for left and right hung doors
- Suitable for use on doors weighing up to 200kg
- Supplied with 40mm single cylinder and fixing pack for combination with internal exit device
- Successfully type tested as part of both single and double door sets in accordance with the requirements of **BS EN1125:2008** and **BS EN179:2008**
- Included as an accessory within CPR Declaration of Performance: HUK0036
- Certifire approved: Certificate CF5180
- Version without cylinder for master keyed applications available - See AR8806
- Backing plate contains protective shroud feature, restricting ability to snap the cylinder

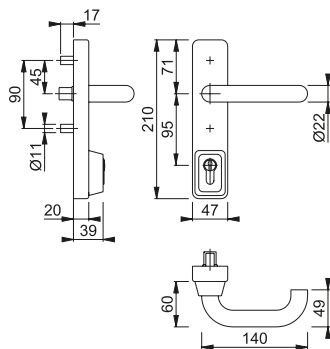

## AR910

ARRONE® euro profile mortice sashlock case:

- 60mm or 80mm backset, 72mm centres, case pierced to accept bolt through furniture and escutcheons at horizontal 38mm centres, single square forend or radiused forend
- Single throw, 20mm projection deadbolt
- CE Marked: Certificate: 1121-CPR-AG0067

3	X	8	1*	0	G	4	B	A	3	0
---	---	---	----	---	---	---	---	---	---	---

- CPR Declaration of Performance: HUK0007
- Certifire approved: Certificate CF530
- Meets dimensional recommendations of BS8300 and ADM for locks
- **The AR900 series lock case has been successfully fire tested with the use of an intumescent kit. The supply and fitting of this intumescent kit is essential to the products compliance with the fire test and CE marking evidence it has gained. HOPPE takes no responsibility for any locks purchased and fitted without sufficient intumescent protection.**

Included in a successful fire test to BS EN1634 Part-1. Suitable for use on 30, 60, 90 and 120 minute timber and 240 minute steel fire doors



square forend



radiused forend

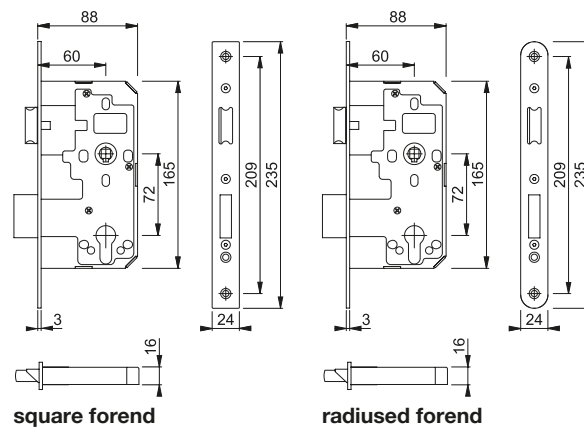



square forend



radiused forend

AR911

- ARRONE® euro profile mortice latch case:
- 60mm or 80mm backset, 72mm centres, case pierced to accept bolt through furniture at horizontal 38mm centres, single square forend or radiused forend
  - CE Marked: Certificate: 1121-CPR-AG0070

3	X	8	1*	0	G	-	B	0	3	0
---	---	---	----	---	---	---	---	---	---	---

- CPR Declaration of Performance: HUK0009
- Certifire approved: Certificate CF530
- Meets dimensional recommendations of BS8300 and ADM for locks
- **The AR900 series lock case has been successfully fire tested with the use of an intumescent kit. The supply and fitting of this intumescent kit is essential to the products compliance with the fire test and CE marking evidence it has gained. HOPPE takes no responsibility for any locks purchased and fitted without sufficient intumescent protection.**

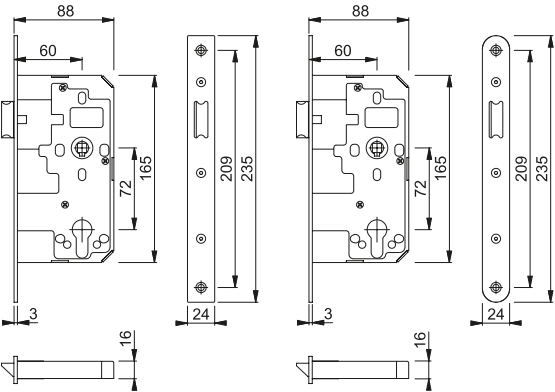

square forend

radiused forend

Included in a successful fire test to BS EN1634 Part-1. Suitable for use on 30, 60, 90 and 120 minute timber and 240 minute steel fire doors

## AR912

ARRONE® Euro profile mortice deadlock case:

- 60mm or 80mm backset, case pierced to accept bolt through escutcheons at horizontal 38mm centres, single square forend or radiused forend
- Single throw, 20mm projection deadbolt
- CE Marked: Certificate: 1121-CPR-AG0068
- CPR Declaration of Performance: HUK0008
- Certifire approved: Certificate CF530

3	X	8	1*	0	G	4	B	A	0	0
---	---	---	----	---	---	---	---	---	---	---

- Meets dimensional recommendations of BS8300 and ADM for locks
- **The AR900 series lock case has been successfully fire tested with the use of an intumescent kit. The supply and fitting of this intumescent kit is essential to the products compliance with the fire test and CE marking evidence it has gained. HOPPE takes no responsibility for any locks purchased and fitted without sufficient intumescent protection.**



square forend



radiused forend

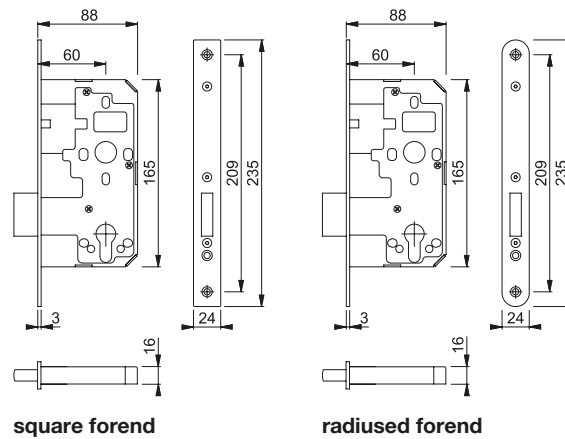

square forend

radiused forend

Included in a successful fire test to BS EN1634 Part-1. Suitable for use on 30, 60, 90 and 120 minute timber and 240 minute steel fire doors





square forend



square forend

AR913

- ARRONE® euro profile mortice latch case:
- 60mm or 80mm backset, 72mm centres, case pierced to accept bolt through furniture at horizontal 38mm centres, single square forend or radiused forend
  - CE Marked: Certificate: 1121-CPR-AG0070

3	X	8	1*	0	G	-	B	0	3	0
---	---	---	----	---	---	---	---	---	---	---

- CPR Declaration of Performance: HUK0009
- Certifire approved: Certificate CF530
- Meets dimensional recommendations of BS8300 and ADM for locks
- **The AR900 series lock case has been successfully fire tested with the use of an intumescent kit. The supply and fitting of this intumescent kit is essential to the products compliance with the fire test and CE marking evidence it has gained. HOPPE takes no responsibility for any locks purchased and fitted without sufficient intumescent protection.**

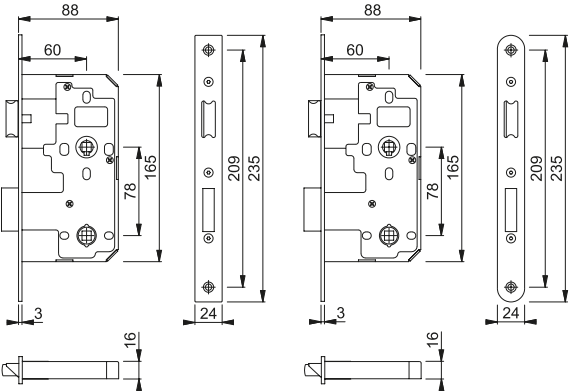

square forend

radiused forend

Included in a successful fire test to BS EN1634 Part-1. Suitable for use on 30, 60, 90 and 120 minute timber and 240 minute steel fire doors



## AR-MK-0122

ARRONE® 6 pin cylinder:

- Euro profile cylinder with DIN type turn master keyed
- Inline (equal dimensions both sides)
- Supplied with 2 servant keys
- Successfully type tested to the requirements of **BS EN1303**

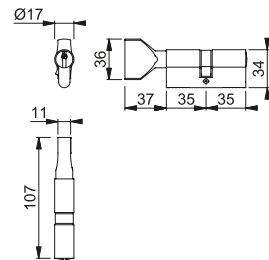

Included in a successful fire test to BS EN1634 Part-1. Suitable for use on 30, 60, 90 and 120 minute timber and 240 minute steel fire doors



## AR-MK-0130

ARRONE® 6 pin cylinder:

- Euro profile double cylinder master keyed
- Inline (equal dimensions both sides) and offset sizes available
- Supplied with 2 servant keys
- Successfully type tested to the requirements of **BS EN1303**

1	6	0	0	0	C	6	0
---	---	---	---	---	---	---	---

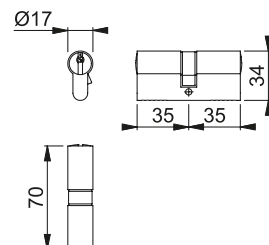

Included in a successful fire test to BS EN1634 Part-1. Suitable for use on 30, 60, 90 and 120 minute timber and 240 minute steel fire doors

# Mechanical Push Button

## AR195



ARRONE® mechanical push button lock:

- Operated by pad lever
- 14 digit pin tumbler system, 8000 code combinations
- Dual function holdback facility (On or Off)
- Non handed, suitable for left or right hand applications
- Suitable for internal use
- Supplied with deadlocking tubular latch with 60mm backset
- Suitable for timber or metal doors from 33mm to 55mm thick

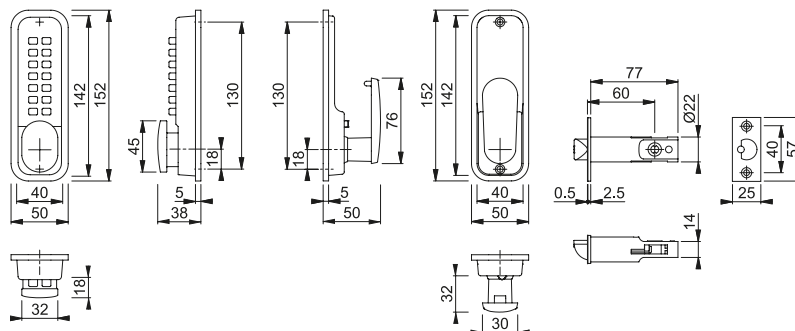

Included in a successful fire test to BS EN1634 Part-1. Suitable for use on 30 and 60 minute timber fire doors

## AR525-MC



ARRONE® lever operated mechanical push button lock:

- Suitable for heavy duty use - offices, schools, warehouses, care homes, hotels and leisure facilities
- Fully reversible return to door lever
- Code free option available
- Non handed, suitable for left or right hand applications
- Available in code free variants
- Supplied with Torx anti tamper fixings
- Supplied with tubular latch to suit 60mm backset - separate tubular latch available to suit 70mm backset
- Rubber backing plate supplied for protection from weathering effects to external doors

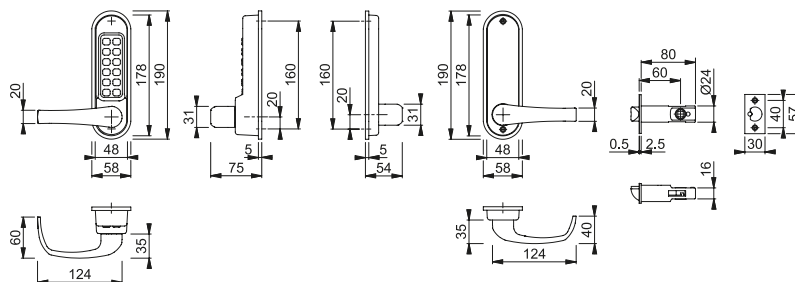

Included in a successful fire test to BS EN1634 Part-1. Suitable for use on 30 and 60 minute timber and 240 minute metal fire doors



## K690 (AR617A)

HOPPE nylon coat hook:

- Fixing: visible, wood screws

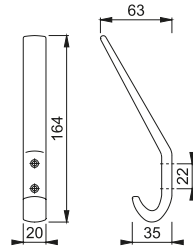

## AR317

ARRONE® hat and coat hook:

- 125mm strip pattern hat and coat hook

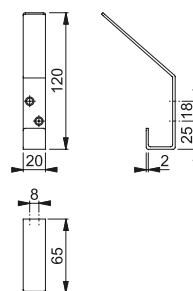



# Floor Fix Door Stop, Signs



## AR334F

ARRONE® floor fix door stop:

- Dome shape floor fix door stop



## AR902 - “Fire door keep shut”

ARRONE® stainless steel information sign:

- 76mm diameter

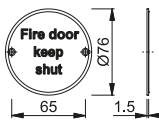

## AR903M - Male WC

ARRONE® stainless steel information sign:

- with pictogram
- 76mm diameter

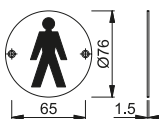



### AR903F - Female WC

ARRONE® aluminium information sign:

- with pictogram
- 76mm diameter

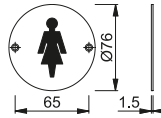

### AR607D - Disabled WC

ARRONE® nylon information sign:

- with pictogram
- 100mm x 150mm

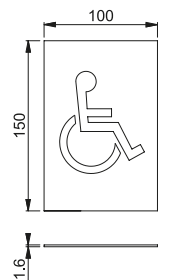

## ARRONE® Antimicrobial Uprights

ARRONE® antimicrobial upright:

- White finish
- Twin slot upright
- Successfully type tested in accordance with ISO 22196:2007 for coated metal surfaces

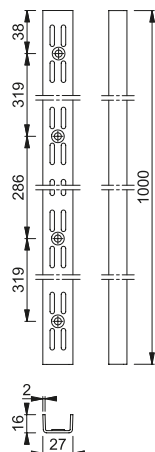

## ARRONE® Antimicrobial Shelving Brackets

ARRONE® antimicrobial shelving bracket:

- White finish
- Successfully type tested in accordance with ISO 22196:2007 for coated metal surfaces

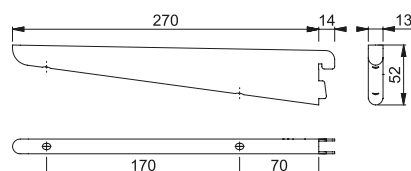

## Aluminium



**F1**  
Silver

## Stainless Steel



**F69** Satin Stainless  
Steel

## Nylon



**F3003** Red  
(Rouge)



**F5002** Cobalt Blue

## ARRONE® – colour chart



SE  
Silver enamel



SSS  
Satin stainless steel



SNP  
Satin nickel plated

\* Suitable for interior applications only.

