



HOPPE Suited Range

About HOPPE (UK)

HOPPE (UK) Ltd. is a specialist manufacturer and supplier of door and window hardware. Established in the UK in 1988, we have become the trusted partner of our customers through our focus on innovation, quality and performance.

As a member of HOPPE Group with its German origins, HOPPE (UK) benefits highly from more than 60 years of experience and knowledge in the field of architectural hardware. HOPPE Group is a company run by the owning family who have always based its leadership on high ethical standards based on values. This attitude creates a correspondingly high quality of interaction with employees and customers alike making "HOPPE – Handle of excellence." a brand-name that stands for innovation and customer-oriented added value. This way HOPPE door and window handles will offer the best possible benefit/price ratio to every market segment.

Complementary products to operate and secure the door such as closers, locks, hinges, access control, etc. are provided by "ARRONE – the Complete Range", a brand of HOPPE Group. ARRONE offers a comprehensive range of products designed for use within the commercial and residential door market. The brand is recognised for offering affordable quality hardware products.



Our dedicated staff is highly skilled, GAI trained and provides award winning service. We invest heavily in stock of core items to satisfy our customers' needs. A purpose built, state-of-the-art distribution centre at Gailey Park, seven miles north of Wolverhampton, provides the ideal location for distribution throughout the UK and Ireland. At 50,000 square feet it offers light and modern facilities for both employees and customers with a fully equipped showroom/meeting room available.

HOPPE (UK) strives for continued excellence through our commitment to long-term trusting partnerships with employees, customers and suppliers and the regions in which the company is located, thus allowing for the best overall value proposition to our strategic market partners – we call that Total Beneficial Advantage.

Find matching handles and accessories with ease

Specifying door and window hardware with matching accessories has never been easier. Have you seen a HOPPE door or window handle that suits your needs? Now you'll find a range of letter plates, knockers, numerals and letters that match the handle perfectly.

It means you can specify door and window hardware without the hassle of searching for complementary accessories.

Matching products in every HOPPE finish

Our complementary products are available in all HOPPE colours and finishes, including our most popular options:

- Polished chrome
- Polished gold
- Powder coated white
- Powder coated black

The benefits

- All products conform to the HOPPE standards of innovation, quality and performance
- Specify handles without the hassle of finding accessories to match
- A full range of matching colours and finishes

A complete range of products designed to meet your needs

The HOPPE range of door and window hardware is complemented perfectly by our ARRONE branded products. Featuring a comprehensive range of products – including door closers, locks, hinges and access control – the ARRONE brand is recognised for offering affordable quality hardware for use within the commercial and residential door market.



HOPPE Complementary Range

HOPPE – Handle of excellence.

Enjoy the feel of quality. Indeed, touching a quality handle reassures you that you have made the right choice. Hardware with this logo  is a brand-name product which keeps its promise of quality to the customer.

HOPPE is the European market leader in the development, manufacturing, and marketing of hardware systems for doors and windows. This company, run by the owning family and based in Switzerland, was founded in 1952, and employs almost 3,000 employees worldwide.

Simple installation

Quick-Fit¹

Installing a door handle usually involves many steps and manual operations. It can be a time consuming and tedious process. However, door handles with the **HOPPE Quick-Fit connection** are installed in just one simple movement. It is quick, easy and secure.

Resista[®] – HOPPE's surface guarantee

Resista[®]

HOPPE Resista[®] hardware has a 10-year surface guarantee. They are therefore ideal for coastal areas and highly frequented areas such as public buildings, shops and hotels.

All products with the Resista[®] surface guarantee have undergone continual quality testing and, when new, conform to the requirements of the European standard **EN 1670** ("Locks and hardware – corrosion resistance – requirements and test methods").



Secured by Design



Police Preferred Specification

Enhanced Security Requirements for Door Assemblies

PAS 24:2012 has been produced by BSI to provide a method for testing and assessing the enhanced security performance requirements of external door sets and window types intended to resist the levels and methods of attack experienced in the UK and normally associated with the casual or opportunist burglar.

Annex A refers to the assessment of Security hardware and cylinder testing. As a supplier of Security Hardware our products will be assessed against Annex A, the door supplier will be responsible for providing evidence of full compliance to PAS 24:2012.

HOPPE security handle sets have been designed to withstand and exceed the 3 minutes attack time contained within PAS 24:2012, Clause A.3.2. Part 1 for security hardware.

ARRONE® – developing and enhancing the product range

Under the ARRONE® brand name, HOPPE Group is able to offer a comprehensive range of architectural quality door and window hardware along with accessories. Many products are manufactured exclusively by leading hardware manufacturers throughout the world. Within the extensive range are door closers, floor springs, emergency exit devices, cylinders, architectural mortice lock cases, hinges, disabled fittings, signs and accessories.

ARRONE® products are designed and manufactured to compliment the HOPPE range of aluminium, brass, stainless steel and nylon door and window hardware.

Launched in 1993 the ARRONE® product range is now firmly recognised and established within the market place. However, ever growing demands for additional feature benefits and product enhancements coupled with changes in legislation has in turn led to extensive product developments and additions throughout the various ranges.

These new products, many of which where applicable, have been successfully type tested and certified to the latest European standards and also satisfy the UK construction product regulations for Ironmongery.

ARRONE®
The **complete** range.





Quick-Fit

Atlanta - 1530/3259N-ZA/3830N

HOPPE aluminium security handle set on narrow backplate with cylinder cover for profile doors:

- Tested to **DIN EN 1906: 26-0040A**
- Bearing: loose door handles, spring cassettes, maintenance-free slide bearing
- Connection: **HOPPE Quick-Fit connection** with HOPPE solid spindle (spindle - receiver components)
- Cylinder cover: hardened steel, for cylinder projection 10-18 mm
- Backplates: with supporting lugs
- Fixing: visible inside, bolt-through, M6 thread screw and M10 thread screw with M6 thread inside

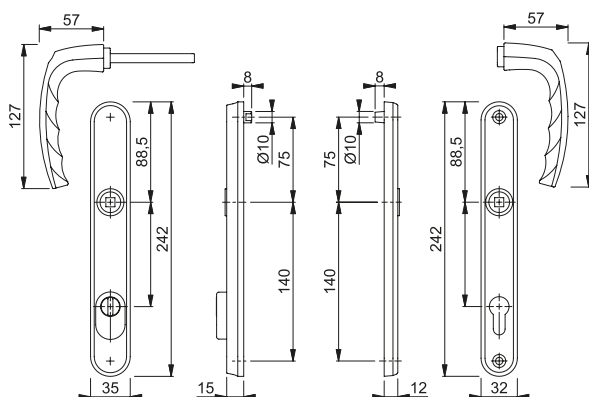

Available colours:

F49

F77

F9016

F9714M

Details

- Product type: Security handle sets
- Category of use: Category of use grade 2 – DIN EN 1906
- Security grade: PAS 24
- Door thickness: 44 mm
- Also available in door thickness: 60 mm or 70 mm
- Spindle size: 8 mm

duraplus®

Secured by Design



Quick-Fit

Atlanta - 1530/3260N-ZA/3831N

HOPPE aluminium security handle set on narrow backplate with cylinder cover for profile doors:

- Tested to **DIN EN 1906: 26-0040A**
- Bearing: loose door handles, spring cassettes, maintenance-free slide bearing
- Connection: **HOPPE Quick-Fit connection** with HOPPE solid spindle (spindle - receiver components)
- Cylinder cover: hardened steel, for cylinder projection 10-18 mm
- Backplates: with supporting lugs
- Fixing: visible inside, bolt-through, M6 thread screw and M10 thread screw with M6 thread inside

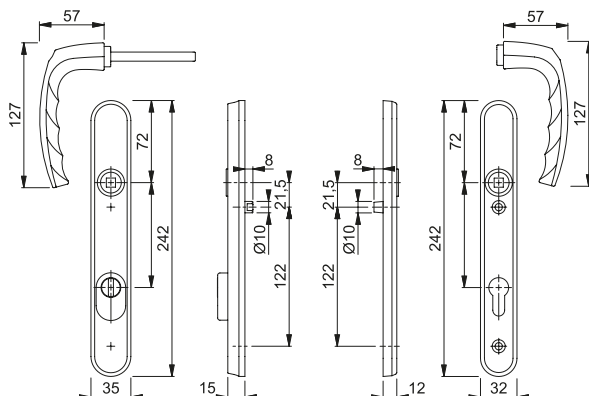

Available colours:

F49

F77

F9016

F9714M

Details

- Product type: Security handle sets
- Category of use: Category of use grade 2 – DIN EN 1906
- Security grade: PAS 24
- Door thickness: 70 mm
- Also available in door thickness: 44 mm or 60 mm
- Spindle size: 8 mm

duraplus®

Secured by Design





Quick-Fit

■ Tōkyō - 1710RH/3259N-ZA/3633N

HOPPE aluminium security handle set on narrow backplate with cylinder cover for profile doors:

- Tested to **DIN EN 1906: 26-0040A**
- Bearing: loose door handles, spring cassettes, maintenance-free slide bearing
- Connection: **HOPPE Quick-Fit connection** with HOPPE solid spindle (spindle - receiver components)
- Cylinder cover: hardened steel, for cylinder projection 10-18 mm
- Backplates: with supporting lugs
- Fixing: visible inside, bolt-through, M6 thread screw and M10 thread screw with M6 thread inside

duraplus®



Police Preferred Specification

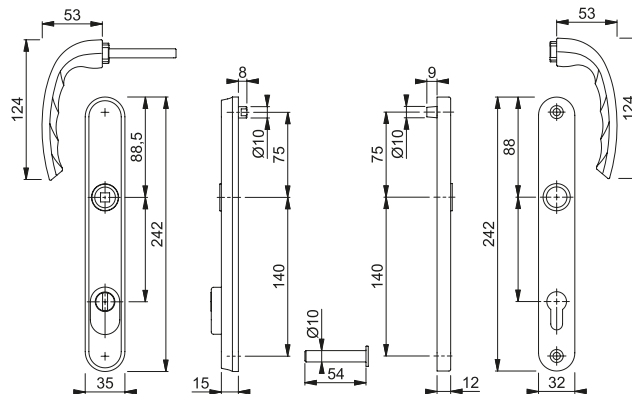

Available colours:

F9016
F9714M

Details

- Product type: Security handle sets
- Keyhole: Euro profile cylinder
- Hole distance: 92 mm
- Category of use: Category of use grade 2 – DIN EN 1906
- Security grade: PAS 24
- Door thickness: 44 mm
- Spindle size: 8 mm

■ Tôkyô - 1710RH/3623N

duraplus®



HOPPE aluminium handle set on narrow backplate for profile doors:

- Tested to **DIN EN 1906: 26-0130A**
- Bearing: sprung fixed/movable door handles, maintenance-free slide bearing
- Connection: HOPPE solid spindle
- Backplates: with supporting lugs
- concealed, bolt-through, M5 thread screws

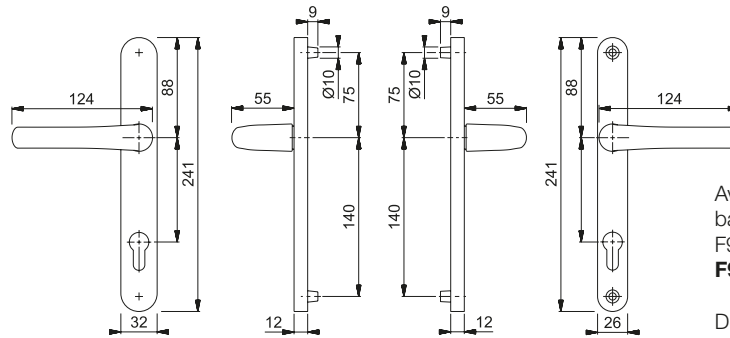

Available colours with narrow backplate (3623N):

F9016

F9714M

Details

- Product type: Set (handle/handle)
- Category of use: Category of use grade 2 – DIN EN 1906
- Door thickness: 60-70 mm
- Also available in door thickness: 62-71 mm
- Spindle size: 8 mm

■ Tôkyô - 1710RH/3370N/3360N

duraplus®



HOPPE aluminium handle set on narrow backplate for profile doors:

- Bearing: fixed/movable door handles, maintenance-free slide bearing
- Connection: HOPPE solid spindle
- Backplate: supporting lugs
- Fixing: visible inside, bolt-through, M6 thread screws

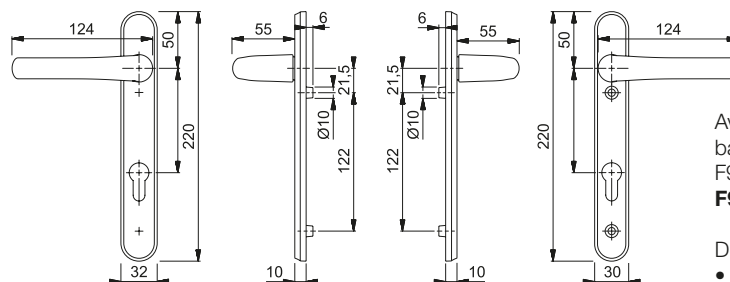

Available colours with narrow backplate (3623N):

F9016

F9714M

Details

- Product type: Set (handle/handle)
- Door thickness: 56-70 mm
- Spindle size: 8 mm



■ Atlanta - 0530S/U26

duraplus®

HOPPE aluminium lockable window handle with **TBT1 operation**:

- Locking mechanism: turn cylinder, reversible key, lockable in the 90° position
- Stop-in position: 90°
- Cover: partial cover cap
- Base: nylon, supporting lugs
- Spindle: HOPPE solid spindle
- Fixing: concealed, M5 thread screws

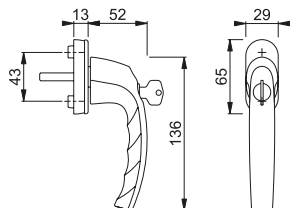

Available colours:

F49

F77

F9016

Details

- Product type: Lockable turn/tilt window handle
- Version: TBT1
- Spindle size: 7 mm
- Spindle length: 32 mm
- Also available in spindle length: 32 mm and 44 mm
- Lug diameter: 10 mm
- Stop position: 90°



■ Tôkyô - 0710S/U26

duraplus®

HOPPE aluminium lockable window handle with **TBT1 operation**:

- Locking mechanism: turn cylinder, reversible key, lockable in the 90° position
- Stop-in position: 90°
- Cover: partial cover cap
- Base: nylon, supporting lugs
- Spindle: HOPPE solid spindle
- Fixing: concealed, M5 thread screws

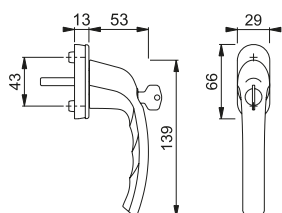

Available colours:

F49

F77

F9016

Details

- Product type: Lockable turn/tilt window handle
- Version: TBT1
- Spindle size: 7 mm
- Spindle length: 32 mm
- Lug diameter: 10 mm
- Stop position: 90°



■ Tôkyô - 0710ES/6

duraplus®

HOPPE aluminium lockable Espagnolette handle:

- Locking mechanism: push button locking cylinder, reversible key
- Stop-in position: none
- Cover: partial cover cap
- Base: aluminium, supporting lugs
- Spindle: HOPPE solid spindle
- Fixing: concealed, for M5 thread screws
- Special feature: for side-hung and top-hung outward opening windows, rotation angle up to 90°, no tilt position; non-lockable version with nylon cylinder cover cap (order separately)

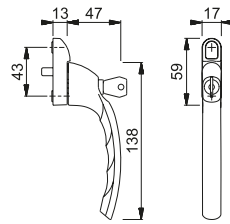

Available colours:

F49

F77

F9016

F9714M

Details

- Product type: Lockable window handle for side-hung windows
- Version: Standard
- Spindle size: 7 mm
- Spindle length: 30 mm
- Also available in spindle length: 40 mm
- Lug diameter: 10 mm

Accessories to complete the HOPPE Door Handle Range

AR708A



ARRONE® letter plates:

- 76 mm x 310 mm sprung letter plate to suit PVCu and composite doors 44 mm to 70 mm
- Secure through fixings ensures letter plate can only be removed from inside the property
- Weather tested in accordance with BS6375-1:2009
- Internal / external letter flap tested internally to 50,000 cycles
- All finishes salt spray tested to 480 hours (BS EN 1670 Class 5)
- Guarantee - 10 years on surface finish and 10 years on mechanical operation
- Tested to PAS24: 2012 Clause 4.3
- Conforms to requirement of BSEN13724:2002

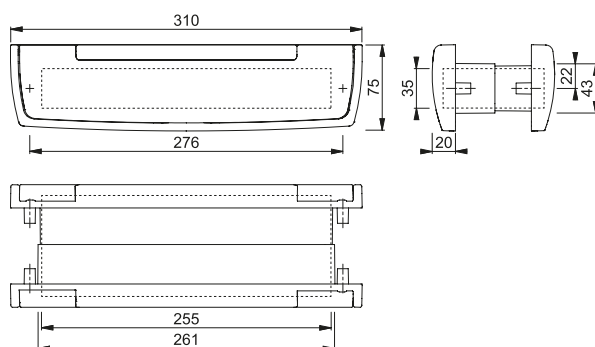

Available colours:
polished chrome plate
polished brass
satin nickel plated
white
black

Details

- Material: zinc
- Product height: 76 mm
- Door type: wooden door/metal door
- Fixings: wood screws/machine screws

AR724



ARRONE® door knocker:

- Designer knocker
- 75 mm x 110 mm
- All finishes salt spray tested to 480 hours (BS EN 1670 Class 5)
- Guarantee - 10 years on surface finish and 10 years on mechanical operation

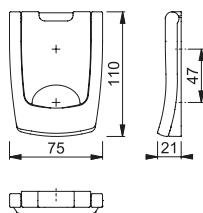

Available colours:
polished chrome plate
polished brass
white
black

Details

- Material: zinc
- Door type: wooden door
- Fixings: wood screws

AR725



ARRONE® door knocker:

- Designer knocker with integrated door viewer
- 75 mm x 110 mm
- All finishes salt spray tested to 480 hours (BS EN 1670 Class 5)
- Guarantee - 10 years on surface finish and 10 years on mechanical operation

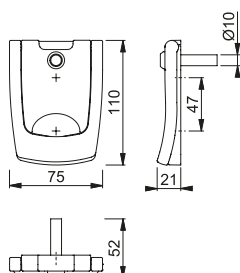

Available colours:
polished chrome plate
polished brass
white
black

Details

- Material: zinc
- Door type: wooden door
- Fixings: wood screws

AR726

ARRONE® door knocker:

- Traditional urn type knocker
- 75 mm x 150 mm
- All finishes salt spray tested to 480 hours (BS EN 1670 Class 5)
- Guarantee - 10 years on surface finish and 10 years on mechanical operation

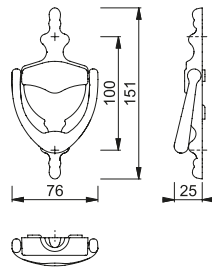

Available colours:
polished chrome plate
polished brass
white
black

Details

- Material: zinc
- Door type: wooden door
- Fixings: wood screws

AR727

ARRONE® door knocker:

- Traditional urn type knocker with integrated door viewer
- 75 mm x 150 mm
- All finishes salt spray tested to 480 hours (BS EN 1670 Class 5)
- Guarantee - 10 years on surface finish and 10 years on mechanical operation

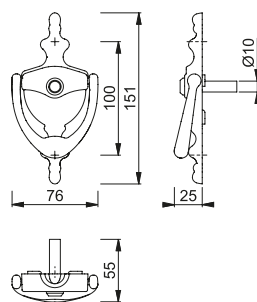

Available colours:
polished chrome plate
polished brass
white
black

Details

- Material: zinc
- Door type: wooden door
- Fixings: wood screws

Accessories to complete the HOPPE Door Handle Range



AR740 (0-9)

ARRONE® numerals and letters:

- All finishes salt spray tested to 480 hours (BS EN 1670 Class 5)

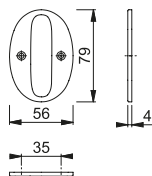

Available colours:
polished chrome plate
polished brass
white
black

Details

- Material: zinc
- Door type: wooden door
- Drilling types: 2 screw holes countersunk
- Fixings: wood screws



AR740 (a-d)

ARRONE® numerals and letters:

- All finishes salt spray tested to 480 hours (BS EN 1670 Class 5)

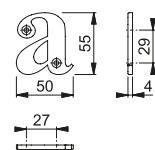









Available colours:
polished chrome plate
polished brass
white
black

Details

- Material: zinc
- Door type: wooden door
- Drilling types: 2 screw holes countersunk
- Fixings: wood screws

Overview of attributes and logos

Denomination	Description	Examples
Brand attributes	<ul style="list-style-type: none"> distinguish all HOPPE products convey the brand promise: <ul style="list-style-type: none"> 10 year guarantee on the mechanical operation Made in Europe DIN EN ISO 14001 Environmentally-considerate manufacturing 	  
Special attributes	<ul style="list-style-type: none"> underline a unique selling proposition or an essential additional benefit of the HOPPE brand product 	Resista® Quick-Fit
Product attributes	<ul style="list-style-type: none"> present important information on a product or a benefit of the product are identified with the pictograms designed by HOPPE 	 Category of use grade 2 (3, 4) to DIN EN 1906  Category of use grade 2 to DIN EN 13126-3  Corrosion resistance EN 1670 (grade 5)  Solid brass
Certification marks	<ul style="list-style-type: none"> identify the products that have been tested by a certification body are known trademarks apply internationally and regionally 	

Aluminium



F49
Polished chrome



F77
Polished brass



F9016
Traffic white



F9714M
Black

For information on alternative versions, please see our on-line product catalogue at www.hoppe.com/gb/en/products or use the QR-code (tab "Products").



Brass



F49-R
Polished chrome – **Resista®**



F77-R
Polished brass colour – **Resista®**

Appointed Distributor:

HOPPE (UK) Ltd
Gailey Park · Gravelly Way · Standeford · Wolverhampton WV10 7GW
Tel. 01902 484 400 · Tel. Sales Direct: 01902 484 410/20
Fax 01902 484 406 · Fax Sales Direct: 01902 484 417/27
www.hoppe.co.uk · info.uk@hoppe.co.uk